



## PORK BRUSHING DEVICE type ZKV



---

**Strojírna Pálava Maxima s.r.o.**

DESÁTKOVÁ 124/15, 623 00 BRNO KOHOUTOVICE  
Manufactory: TOVÁRNÍ 34, 679 32 SVITÁVKA, CZECH REPUBLIC  
tel: +420 - 516 453 834, fax: +420 - 516 453 834  
e-mail: [info@s-palava.cz](mailto:info@s-palava.cz); [www.s-palava.cz](http://www.s-palava.cz)

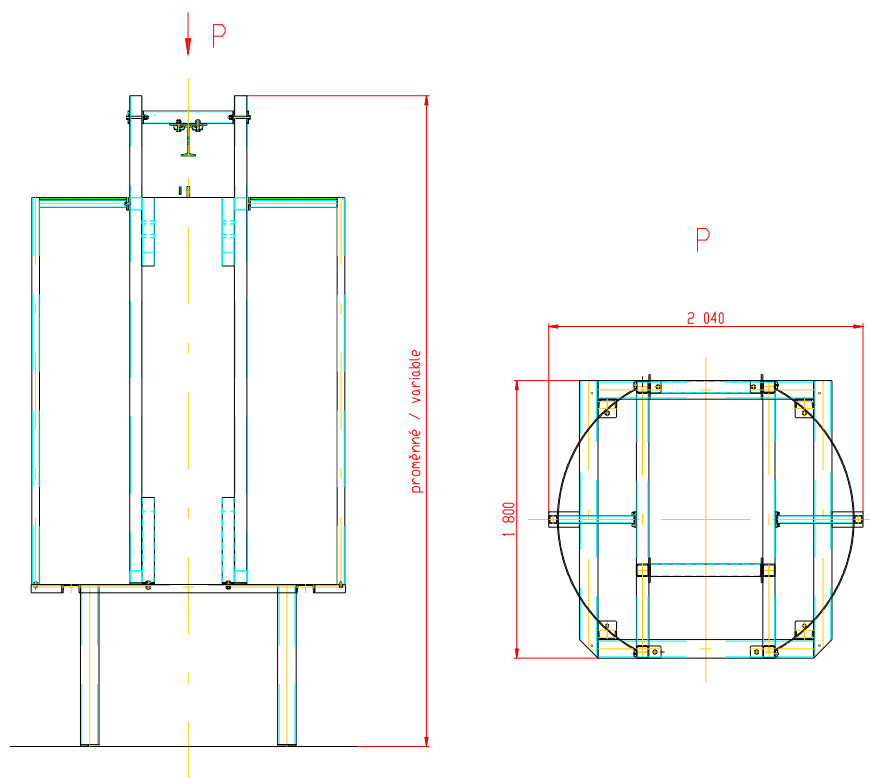

Brushing device is used for pork slaughter. It functions to pig's cleaning at bleeding railway before coming to scalding tube. Device is made out of stainless profile and plastic boards. There are located two rotating brushes, which are driven by electric gear-boxes Nord. Showering is started up automatically with passing hanging carcass..

The height of device depends on height of supporting structure conveyor and railway.

### Technical data

Length	1800 mm
Width	2040 mm
Height	According to supporting structure
Input	2 x 3 kW
Connection for water-service pipe	1 "
Water pressure	0,6 MPa